



CARATTERISTICHE TECNICHE
 TECHNICAL CHARACTERISTICS
 TECHNISCHE ANGABEN
 CARACTÉRISTIQUES TECHNIQUES
 CARACTERÍSTICAS TÉCNICAS
 CARACTERÍSTICAS TÉCNICAS



Norma di Riferimento
 Reference standard
 Entspricht der Norm
 Norme de référence
 Normativa de referencia
 Norma de referência

1907/2006
 REACH ✓
 2011/65/CE
 RoHS ✓
 PED
 2014/68/UE
 SILICON
 FREE

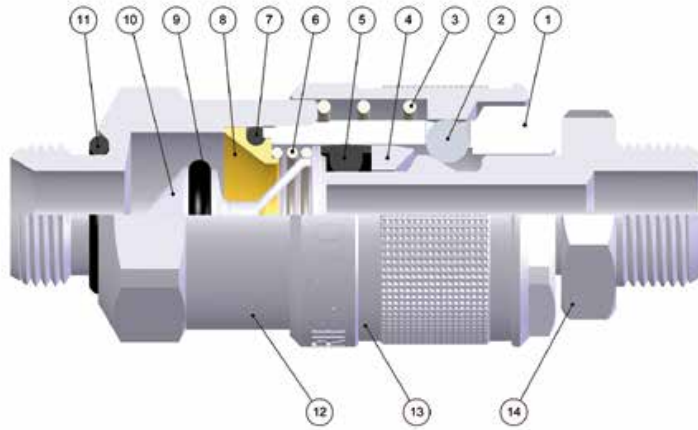

FKM A RICHIESTA
 IF REQUESTED FKM
 FKM AUF ANFRAGE
 FKM SUR DEMANDE
 FKM BAJO DEMANDA
 FKM SOB ENCOMENDA

DN
 5.5 mm

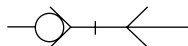

SWISS

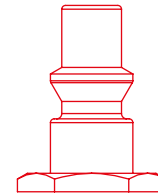

1:1

| Materiali e Componenti | IT | Component Parts and Materials | GB | Komponenten und Materialien | DE |
|--------------------------------------------|----|--------------------------------------------|----|-------------------------------------------|----|
| 1 Corpo in Ottone Nichelato | | 1 Nickel-Plated Brass Body | | 1 Körper Messing Vernickelt | |
| 2 Sfera in Acciaio AISI 420 | | 2 Stainless Steel AISI 420 Balls | | 2 Kugel Edelstahl AISI 420 | |
| 3 Molla Ghiera in Acciaio AISI 302 | | 3 Stainless Steel AISI 302 Ring Nut Spring | | 3 Entriegelungsfeder Edelstahl AISI 302 | |
| 4 Anello Guida innesto in Ottone Nichelato | | 4 Nickel-Plated Brass Guide Ring Coupling | | 4 Stecker Führungsring Messing Vernickelt | |
| 5 Guarnizione Corpo Sagomata in NBR | | 5 NBR Body Molded Seals | | 5 Dichtung NBR | |
| 6 Molla Otturatore in Acciaio AISI 302 | | 6 Stainless Steel AISI 302 Shutter Spring | | 6 Verschlussfeder Edelstahl AISI 302 | |
| 7 Guarnizione O-Ring in NBR | | 7 NBR O-Ring Seals | | 7 O-Ring NBR | |
| 8 Anello in ottone | | 8 Brass Ring | | 8 Ring Aus Messing | |
| 9 Guarnizione O-Ring in NBR | | 9 NBR O-Ring Seals | | 9 O-Ring NBR | |
| 10 Otturatore in Zama | | 10 Zamak Shutter | | 10 Verschluss Aus Zamak | |
| 11 Guarnizione O-Ring Filetto in NBR | | 11 NBR Thread O-Ring Seals | | 11 O-Ring NBR | |
| 12 Attacco Terminale In Ottone Nichelato | | 12 Nickel-Plated Brass Coupling Back Part | | 12 Einschraubkörper Messing Vernickelt | |
| 13 Ghiera in Ottone Nichelato | | 13 Nickel-Plated Brass Sleeve | | 13 Entriegelungshülse Messing Vernickelt | |
| 14 Innesto in Ottone Nichelato | | 14 Nickel-Plated Brass Plug Outline | | 14 Stecker Messing Vernickelt | |

| Matériaux et Composants | FR | Materiales y Componentes | ES | Materialis e Componentes | PT |
|------------------------------------------------|----|------------------------------------------|----|----------------------------------------|----|
| 1 Corps: Laiton Nickelé | | 1 Cuerpo en latón niquelado | | 1 Corpo em Latão Niquelado | |
| 2 Bille: Acier Inoxydable AISI 420 | | 2 Esfera en acero AISI 420 | | 2 Esfera em aço AISI 420 | |
| 3 Ressort de Bague: Acier Inoxydable AISI 302 | | 3 Muelle tuerca en acero AISI 302 | | 3 Mola da porca em aço AISI 302 | |
| 4 Bague de Guidage: Laiton Nickelé | | 4 Anillo guía enchufe en latón niquelado | | 4 Anel guia do plug em latão niquelado | |
| 5 Joint en NBR | | 5 Junta en NBR | | 5 Vedação em NBR | |
| 6 Ressort de Clapet: Acier Inoxydable AISI 302 | | 6 Muelle obturador en acero AISI 302 | | 6 Mola do obturador em aço AISI 302 | |
| 7 Joint Torique en NBR | | 7 Junta tórica en NBR | | 7 Vedação O-Ring em NBR | |
| 8 Bague en Laiton | | 8 Anillo en latón | | 8 Anel em latão | |
| 9 Joint Torique en NBR | | 9 Junta tórica en NBR | | 9 Vedação O-Ring em NBR | |
| 10 Clapet En Zamak | | 10 Obturador en Zamak | | 10 Obturador em Zamak | |
| 11 Joint Torique en NBR | | 11 Junta tórica en NBR | | 11 Vedação O-Ring em NBR | |
| 12 Corps: Laiton Nickelé | | 12 Conexión terminal en latón niquelado | | 12 Conexão terminal em latão niquelado | |
| 13 Bague: Laiton Nickelé | | 13 Tuerca en latón niquelado | | 13 Porca em latão niquelado | |
| 14 Embout: Laiton Nickelé | | 14 Enchufe en latón niquelado | | 14 Plug em latão niquelado | |

Архангельск (8182)63-90-72
 Астана (7172)727-132
 Астрахань (8512)99-46-04
 Барнаул (3852)73-04-60
 Белгород (4722)40-23-64
 Брянск (4832)59-03-52
 Владивосток (423)249-28-31
 Волгоград (844)278-03-48
 Вологда (8172)26-41-59
 Воронеж (473)204-51-73
 Екатеринбург (343)384-55-89
 Иваново (4932)77-34-06

Ижевск (3412)26-03-58
 Иркутск (395)279-98-46
 Казань (843)206-01-48
 Калининград (4012)72-03-81
 Калуга (4842)92-23-67
 Кемерово (3842)65-04-62
 Киров (8332)68-02-04
 Краснодар (861)203-40-90
 Красноярск (391)204-63-61
 Курск (4712)77-13-04
 Липецк (4742)52-20-81
 Киргизия (996)312-96-26-47

Магнитогорск (3519)55-03-13
 Москва (495)268-04-70
 Мурманск (8152)59-64-93
 Набережные Челны (8552)20-53-41
 Нижний Новгород (831)429-08-12
 Новокузнецк (3843)20-46-81
 Новосибирск (383)227-86-73
 Омск (3812)21-46-40
 Орел (4862)44-53-42
 Оренбург (3532)37-68-04
 Пенза (8412)22-31-16
 Казахстан (772)734-952-31

Пермь (342)205-81-47
 Ростов-на-Дону (863)308-18-15
 Рязань (4912)46-61-64
 Самара (846)206-03-16
 Санкт-Петербург (812)309-46-40
 Саратов (845)249-38-78
 Севастополь (8692)22-31-93
 Симферополь (3652)67-13-56
 Смоленск (4812)29-41-54
 Сочи (862)225-72-31
 Ставрополь (8652)20-65-13
 Таджикистан (992)427-82-92-69

Сургут (3462)77-98-35
 Тверь (4822)63-31-35
 Томск (3822)98-41-53
 Тула (4872)74-02-29
 Тюмень (3452)66-21-18
 Ульяновск (8422)24-23-59
 Уфа (347)229-48-12
 Хабаровск (4212)92-98-04
 Челябинск (351)202-03-61
 Череповец (8202)49-02-64
 Ярославль (4852)69-52-93

**Pressione d'esercizio***Working Pressures**Betriebsdruck**Pression de service**Presión de Ejercicio**Pressão de Trabalho***-0.99 bar****16 bar****Max pressione statica (no pulsazioni)***Maximum static pressure (no pulsations)**Maximaler statischer Betriebsdruck (ohne pulsations)**Pression statique maximale (sans pulsation)**Presión estática máxima (sin pulsaciones)**Pressão estática máxima (sem pulsações)***35 bar****Temperature***Temperatures**Temperatur**Températures**Temperaturas**Temperaturas***- 20 °C****+ 80 °C***Con O-ring in FKM**With FKM O-ring**Mit O-ring in FKM**Avec joints en FKM**Con junta tórica en FKM**Com O-ring em FKM***- 10 °C****+ 200 °C****Fluidi compatibili***Aria compressa**Fluids**Compressed air**Geeignete Medien**Druckluft**Fluides compatibles**Air comprimé**Fluidos compatibles**Aire comprimido**Fluidos compatíveis**Ar comprimido***Per altri fluidi, consultare l'ufficio tecnico Aignep.***For other fluids, consult the technical department Aignep.**Für andere Flüssigkeiten, kontaktieren Sie uns.**Pour d'autres fluides, veuillez nous consulter.**Para otros fluidos póngase en contacto con el departamento técnico Aignep.**Para outros fluidos consulte o departamento técnico da Aignep.***Portata****NI/min***Flow Rate**Durchflusswerte**Débit**Caudal de Flujo**Vazão***6 bar****Δ 1****1300****6 bar****Δ 0.5****1000****6 bar*********1650**** Scarico libero - Exhaust Free - Kostenlose Auspuff - Échappement libre - Escape Libre - Descarga livre.***Filettatura****IT***Gas cilindrica conforme ISO 228 Classe A.***Threads****GB***Parallel gas in conformity with ISO 228 Class A.***Gewindearten****DE***Zylindrisches Gewinde nach Norm ISO 228 Classe A.***Filetages****FR***Filetage cylindrique conforme: ISO 228 Class A.***Roscas****ES***Gas cilíndrica conforme ISO 228 Clase A.***Roscas****PT***Gas paralela conforme ISO 228 Classe A.*

171

PRESA MASCHIO

MALE SOCKET
 VERSCHLUSS-KUPPLUNG MIT AUSSENGEWINDE
 COUPLEUR MÂLE
 ENCHUFE MACHO
 SOQUETE COM ROSCA MACHO

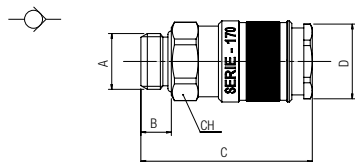

| Code | A | B | C | D | CH | Pack. |
|--------------|-----|----|----|----|----|-------|
| 00171 00 001 | 1/4 | 8 | 50 | 24 | 21 | 10 |
| 00171 00 002 | 3/8 | 9 | 51 | 24 | 21 | 10 |
| 00171 00 003 | 1/2 | 10 | 52 | 24 | 24 | 10 |

172

PRESA FEMMINA

FEMALE SOCKET
 VERSCHLUSS-KUPPLUNG MIT INNENGEWINDE
 COUPLEUR FEMELLE
 ENCHUFE HEMBRA
 SOQUETE COM ROSCA FÊMEA

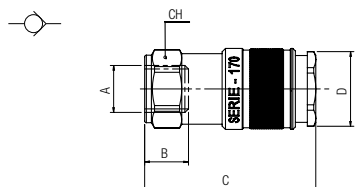

| Code | A | B | C | D | CH | Pack. |
|--------------|-----|----|------|----|----|-------|
| 00172 00 001 | 1/4 | 12 | 51 | 24 | 21 | 10 |
| 00172 00 002 | 3/8 | 12 | 52 | 24 | 21 | 10 |
| 00172 00 003 | 1/2 | 15 | 56,5 | 24 | 24 | 10 |

271

INNESTO MASCHIO

MALE PLUG
 STECKER MIT AUSSENGEWINDE
 EMBOUT MÂLE
 ADAPTADOR MACHO
 PLUG COM ROSCA MACHO

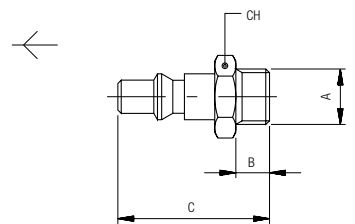

| Code | A | B | C | CH | Pack. |
|-------------------|-----|----|------|----|-------|
| 00271 00 01 03 NB | 1/4 | 8 | 36 | 17 | 10 |
| 00271 00 01 04 NB | 3/8 | 9 | 37 | 19 | 10 |
| 00271 00 01 05 NB | 1/2 | 10 | 38.5 | 24 | 10 |

271AC

INNESTO IN ACCIAIO MASCHIO

STEEL MALE PLUG
 STECKER MIT AUSSENGEWINDE AUS STAHL
 EMBOUT MÂLE EN ACIER
 ADAPTADOR EN ACERO MACHO
 PLUG EM AÇO COM ROSCA MACHO

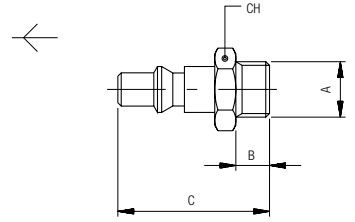

| Code | A | B | C | CH | Pack. |
|-------------------|-----|----|------|----|-------|
| 271AC 00 51 03 ZI | 1/4 | 8 | 36 | 17 | 10 |
| 271AC 00 51 04 ZI | 3/8 | 9 | 37 | 19 | 10 |
| 271AC 00 51 05 ZI | 1/2 | 10 | 38.5 | 24 | 10 |

Acciaio Indurito
 Hardened Steel
 Gehärtetem Stahl
 Acier Trempé
 Acero Curtido
 Aço Endurecido

272

INNESTO FEMMINA

FEMALE PLUG
 STECKER MIT INNENGEWINDE
 EMBOUT FEMELLE
 ADAPTADOR HEMBRA
 PLUG COM ROSCA FÊMEA

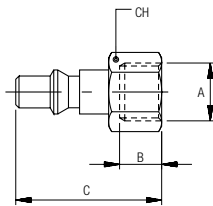

| Code | A | B | C | CH | Pack. |
|-------------------|-----|------|------|----|-------|
| 00272 00 01 03 NB | 1/4 | 11 | 36 | 17 | 10 |
| 00272 00 01 04 NB | 3/8 | 11.5 | 36.5 | 19 | 10 |
| 00272 00 01 05 NB | 1/2 | 14 | 39 | 24 | 10 |

272AC

INNESTO IN ACCIAIO FEMMINA

STEEL FEMALE PLUG
 STECKER MIT INNENGEWINDE AUS STAHL
 EMBOUT FEMELLE EN ACIER
 ADAPTADOR EN ACERO HEMBRA
 PLUG EM AÇO COM ROSCA FÊMEA

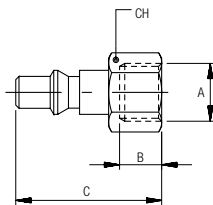

| Code | A | B | C | CH | Pack. |
|-------------------|-----|------|------|----|-------|
| 272AC 00 51 03 ZI | 1/4 | 11 | 36 | 17 | 10 |
| 272AC 00 51 04 ZI | 3/8 | 11.5 | 36.5 | 19 | 10 |
| 272AC 00 51 05 ZI | 1/2 | 14 | 39 | 24 | 10 |

Acciaio Indurito
 Hardened Steel
 Gehärtetem Stahl
 Acier Trempé
 Acero Curtido
 Aço Endurecido

273

INNESTO A CALZAMENTO CON MOLLA

COMPRESSION PLUG WITH SPRINGS
 STECKER MIT KNICKSCHUTZFEDER
 EMBOUT AVEC RESSORT DE PROTECTION
 ADAPTADOR TUBO CON MUELLE
 PLUG COM CONEXÃO PUSH-ON COM MOLA

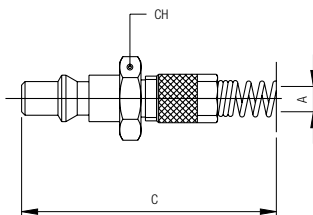

| Code | A | C | CH | Pack. |
|--------------|-------|-------|----|-------|
| 00273 00 001 | 6/4 | 122.5 | 13 | 10 |
| 00273 00 002 | 8/6 | 128 | 13 | 10 |
| 00273 00 003 | 10/8 | 135.5 | 14 | 10 |
| 00273 00 004 | 12/10 | 146 | 16 | 10 |

Molla Acciaio Inox AISI 304 - EN 1.4301
 Stainless Steel Spring AISI 304 - EN 1.4301
 Edelstahlfeder AISI 304 - EN 1.4301
 Ressort Acier Inoxydable AISI 304 - EN 1.4301
 Muelle Acero Inoxidable AISI 304 - EN 1.4301
 Mola Aço Inoxidável AISI 304 - EN 1.4301

274

INNESTO A CALZAMENTO

COMPRESSION PLUG
 STECKER MIT ÜBERWURFVERSCHRAUBUNG
 EMBOUT À RACCORD À COIFFE
 ADAPTADOR TUBO
 PLUG COM CONEXÃO PUSH-ON

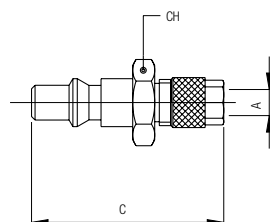

| Code | A | C | CH | Pack. |
|--------------|-------|------|----|-------|
| 00274 00 001 | 6/4 | 41.5 | 13 | 10 |
| 00274 00 002 | 8/6 | 41.5 | 13 | 10 |
| 00274 00 003 | 10/8 | 42.5 | 14 | 10 |
| 00274 00 004 | 12/10 | 44.5 | 16 | 10 |

275

INNESTO CON PORTAGOMMA A RESCA

PLUG WITH REST FOR RUBBER HOSE

STECKER MIT SCHLAUCHTÜLLE

EMBOUT À DOUILLE ANNELÉE POUR TUBE

ADAPTADOR ESPIGA

PLUG COM ESPIGÃO PARA TUBO DE BORRACHA

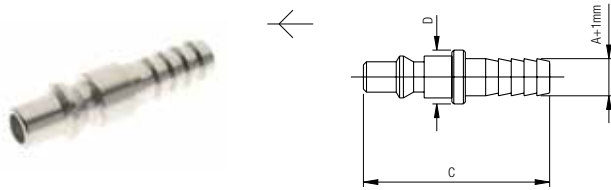

| Code | A | C | D | Pack. |
|-------------------|----|------|----|-------|
| 00275 00 01 X4 NB | 6 | 42.5 | 11 | 10 |
| 00275 00 01 X7 NB | 8 | 42.5 | 11 | 10 |
| 00275 00 01 X9 NB | 10 | 45.5 | 14 | 10 |
| 00275 00 01 Y1 NB | 12 | 45.5 | 16 | 10 |

275AC

INNESTO IN ACCIAIO CON PORTAGOMMA A RESCA

STEEL PLUG WITH REST FOR RUBBER HOSE

STECKER MIT SCHLAUCHTÜLLE AUS STAHL

EMBOUT À DOUILLE ANNELÉE POUR TUBE EN ACIER

ADAPTADOR EN ACERO ESPIGA

PLUG EM AÇO COM ESPIGÃO PARA TUBO DE BORRACHA

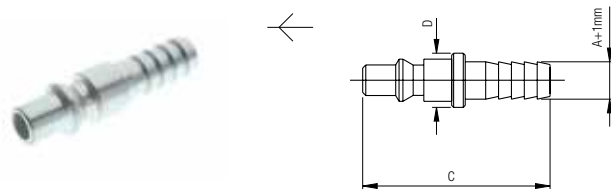

| Code | A | C | D | Pack. |
|-------------------|----|------|----|-------|
| 275AC 00 51 X4 ZI | 6 | 42.5 | 11 | 10 |
| 275AC 00 51 X7 ZI | 8 | 42.5 | 11 | 10 |
| 275AC 00 51 X9 ZI | 10 | 45.5 | 14 | 10 |
| 275AC 00 51 Y1 ZI | 12 | 45.5 | 16 | 10 |

Acciaio Indurito
Hardened Steel
Gehärtetem Stahl
Acier Trempé
Acero Curtido
Aço Endurecido

277

INNESTO A BAIONETTA

BAYONET PLUG

STECKER MIT BAJONETT-VERSCHLUSS

EMBOUT À RACCORD À BAIONNETTE

ADAPTADOR BAYONETA

PLUG COM CONEXÃO TIPO BAIONETA

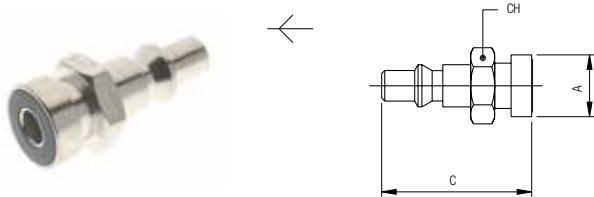

| Code | A | C | CH | Pack. |
|--------------|----|------|----|-------|
| 00277 00 001 | 15 | 36.5 | 15 | 10 |

278

INNESTO A SCARICO PROGRESSIVO

PLUG WITH GRADUAL EXHAUST

STECKER MIT PROGRESSIVER ENTLASTUNG

EMBOUT À PASSAGE PROGRESSIF

ADAPTADOR DE DESCARGA PROGRESIVA

PLUG COM ESCAPE PROGRESSIVO

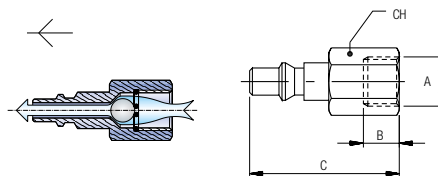

| Code | A | B | C | CH | Pack. |
|--------------|-----|----|------|----|-------|
| 00278 00 001 | 1/4 | 11 | 44.5 | 17 | 10 |

Архангельск (8182)63-90-72
Астана (7172)727-132
Астрахань (8512)99-46-04
Барнаул (3852)73-04-60
Белгород (4722)40-23-64
Брянск (4832)59-03-52
Владивосток (423)249-28-31
Волгоград (844)278-03-48
Вологда (8172)26-41-59
Воронеж (473)204-51-73
Екатеринбург (343)384-55-89
Иваново (4932)77-34-06

Ижевск (3412)26-03-58
Иркутск (395)279-98-46
Казань (843)206-01-48
Калининград (4012)72-03-81
Калуга (4842)92-23-67
Кемерово (3842)65-04-62
Киров (8332)68-02-04
Краснодар (861)203-40-90
Красноярск (391)204-63-61
Курск (4712)77-13-04
Липецк (4742)52-20-81
Киргизия (996)312-96-26-47

Магнитогорск (3519)55-03-13
Москва (495)268-04-70
Мурманск (8152)59-64-93
Набережные Челны (8552)20-53-41
Нижний Новгород (831)429-08-12
Новокузнецк (3843)20-46-81
Новосибирск (383)227-86-73
Омск (3812)21-46-40
Орел (4862)44-53-42
Оренбург (3532)37-68-04
Пенза (8412)22-31-16
Казахстан (772)734-952-31

Пермь (342)205-81-47
Ростов-на-Дону (863)308-18-15
Рязань (4912)46-61-64
Самара (846)206-03-16
Санкт-Петербург (812)309-46-40
Саратов (845)249-38-78
Севастополь (8692)22-31-93
Симферополь (3652)67-13-56
Смоленск (4812)29-41-54
Сочи (862)225-72-31
Ставрополь (8652)20-65-13
Таджикистан (992)427-82-92-69

Сургут (3462)77-98-35
Тверь (4822)63-31-35
Томск (3822)98-41-53
Тула (4872)74-02-29
Тюмень (3452)66-21-18
Ульяновск (8422)24-23-59
Уфа (347)229-48-12
Хабаровск (4212)92-98-04
Челябинск (351)202-03-61
Череповец (8202)49-02-64
Ярославль (4852)69-52-93