



**CARATTERISTICHE TECNICHE**

TECHNICAL CHARACTERISTICS  
TECHNISCHE ANGABEN  
CARACTÉRISTIQUES TECHNIQUES  
CARACTERÍSTICAS TÉCNICAS  
CARACTERÍSTICAS TÉCNICAS



**Norma di Riferimento**

Reference standard  
Entspricht der Norm  
Norme de référence  
Normativa de referencia  
Norma de referència

1907/2006 <b>REACH</b> ✓	2011/65/CE <b>RoHS</b> ✓
PED 2014/68/UE	SILICON FREE

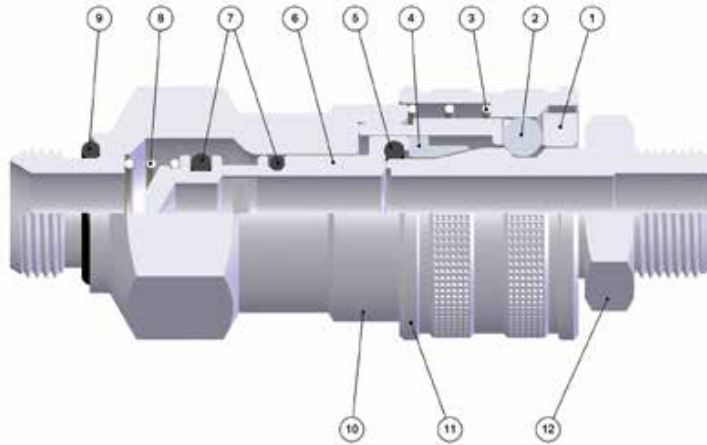

**FKM A RICHIESTA**  
IF REQUESTED FKM  
FKM AUF ANFRAGE  
FKM SUR DEMANDE  
FKM BAJO DEMANDA  
FKM SOB ENCOMENDA

DN  
7.5 mm

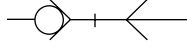

JAPANESE

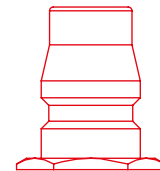

1:1

**Materiali e Componenti**

IT

- Corpo in Ottone Nichelato
- Sfera in Acciaio AISI 420
- Molla Ghiera in Acciaio AISI 302
- Anello Guida Innesto in Acciaio AISI 303
- Guarnizione O-Ring in NBR
- Otturatore in Ottone Nichelato
- Guarnizione O-Ring in NBR
- Molla Otturatore in Acciaio AISI 302
- Guarnizione O-Ring Filetto attacco finale in NBR
- Attacco Terminale in Ottone Nichelato
- Ghiera in Ottone Nichelato
- Innesto in Acciaio

**Component Parts and Materials**

GB

- Nickel-Plated Brass Body
- Stainless Steel AISI 420 Balls
- Stainless Steel AISI 302 Ring Nut Spring
- Stainless Steel AISI 303 Guide Ring Coupling
- NBR O-Ring Seals
- Nickel-Plated Brass Shutter
- NBR O-Ring Seals
- Stainless Steel AISI 302 Shutter Spring
- Thread Final Connection NBR O-Ring Seals
- Nickel-Plated Brass Coupling Back Part
- Nickel-Plated Brass Sleeve
- Steel Plug Outline

**Komponenten und Materialien**

DE

- Körper Messing Vernickelt
- Kugel Edelstahl AISI 420
- Entriegelungsfeder Edelstahl AISI 302
- Führungsring Edelstahl AISI 303
- O-Ring NBR
- Verschluss Messing Vernickelt
- O-Ring NBR
- Verschlussfeder Edelstahl AISI 302
- O-Ring NBR
- Einschraubkörper Messing Vernickelt
- Entriegelungshülse Messing Vernickelt
- Stecker Stahl

**Matériaux et Composants**

FR

- Corps: Laiton Nickelé
- Bille: Acier Inoxydable AISI 420
- Ressort de Bague: Acier Inoxydable AISI 302
- Bague: Acier Inoxydable AISI 303
- Joint Torique en NBR
- Clapet: Laiton Nickelé
- Joint Torique en NBR
- Ressort de Clapet: Acier Inoxydable AISI 302
- Joint Torique en NBR
- Corps: Laiton Nickelé
- Bague: Laiton Nickelé
- Embout: Acier

**Materiales y Componentes**

ES

- Cuerpo en latón niquelado
- Esfera en acero AISI 420
- Muelle tuerca en acero AISI 302
- Anillo guía enchufe en latón niquelado
- Junta tórica en NBR
- Obturador en latón niquelado
- Junta tórica en NBR
- Muelle obturador en acero AISI 302
- O-Ring hilo NBR ataque final
- Conexión terminal en latón niquelado
- Tuerca en latón niquelado
- Adaptador en acero

**Materiais e Componentes**

PT

- Corpo em latão niquelado
- Esfera em aço AISI 420
- Mola de porca em aço AISI 302
- Anel guia do plug em latão niquelado
- Vedação O-Ring em NBR
- Obturador em latão niquelado
- Vedação O-Ring em NBR
- Mola do obturador em aço AISI 302
- O-Ring NBR fio ataque final
- Conexão terminal em latão niquelado
- Porca em latão niquelado
- Plug em aço

Архангельск (8182)63-90-72  
Астана (7172)727-132  
Астрахань (8512)99-46-04  
Барнаул (3852)73-04-60  
Белгород (4722)40-23-64  
Брянск (4832)59-03-52  
Владивосток (423)249-28-31  
Волгоград (844)278-03-48  
Вологда (8172)26-41-59  
Воронеж (473)204-51-73  
Екатеринбург (343)384-55-89  
Иваново (4932)77-34-06

Ижевск (3412)26-03-58  
Иркутск (395)279-98-46  
Казань (843)206-01-48  
Калининград (4012)72-03-81  
Калуга (4842)92-23-67  
Кемерово (3842)65-04-62  
Киров (8332)68-02-04  
Краснодар (861)203-40-90  
Красноярск (391)204-63-61  
Курск (4712)77-13-04  
Липецк (4742)52-20-81  
Киргизия (996)312-96-26-47

Магнитогорск (3519)55-03-13  
Москва (495)268-04-70  
Мурманск (8152)59-64-93  
Набережные Челны (8552)20-53-41  
Нижегород (831)429-08-12  
Новокузнецк (3843)20-46-81  
Новосибирск (383)227-86-73  
Омск (3812)21-46-40  
Орел (4862)44-53-42  
Оренбург (3532)37-68-04  
Пенза (8412)22-31-16  
Казахстан (772)734-952-31

Пермь (342)205-81-47  
Ростов-на-Дону (863)308-18-15  
Рязань (4912)46-61-64  
Самара (846)206-03-16  
Санкт-Петербург (812)309-46-40  
Саратов (845)249-38-78  
Севастополь (8692)22-31-93  
Симферополь (3652)67-13-56  
Смоленск (4812)29-41-54  
Сочи (862)225-72-31  
Ставрополь (8652)20-65-13  
Таджикистан (992)427-82-92-69

Сургут (3462)77-98-35  
Тверь (4822)63-31-35  
Томск (3822)98-41-53  
Тула (4872)74-02-29  
Тюмень (3452)66-21-18  
Ульяновск (8422)24-23-59  
Уфа (347)229-48-12  
Хабаровск (4212)92-98-04  
Челябинск (351)202-03-61  
Череповец (8202)49-02-64  
Ярославль (4852)69-52-93

**Pressione d'esercizio***Working Pressures**Betriebsdruck**Pression de service**Presión de Ejercicio**Pressão de Trabalho***0 bar****25 bar****Temperature***Temperatures**Temperatur**Températures**Temperaturas**Temperaturas***- 20 °C****+ 80 °C***Con O-ring in FKM**With FKM O-ring**Mit O-ring in FKM**Avec joints en FKM**Con junta tórica en FKM**Com O-ring em FKM***- 10 °C****+ 200 °C****Max pressione statica (no pulsazioni)***Maximum static pressure (no pulsations)**Maximaler statischer Betriebsdruck (ohne pulsations)**Pression statique maximale (sans pulsation)**Presión estática máxima (sin pulsaciones)**Pressão estática máxima (sem pulsações)***35 bar****Fluidi compatibili***Aria compressa**Fluids**Compressed air**Geeignete Medien**Druckluft**Fluides compatibles**Air comprimé**Fluidos compatibles**Aire comprimido**Fluidos compatíveis**Ar comprimido**Per altri fluidi, consultare l'ufficio tecnico Aignep.**For other fluids, consult the technical department Aignep.**Für andere Flüssigkeiten, kontaktieren Sie uns.**Pour d'autres fluides, veuillez nous consulter.**Para otros fluidos póngase en contacto con el departamento técnico Aignep.**Para outros fluidos consulte o departamento técnico da Aignep.***Portata****NI/min***Flow Rate**Durchflusswerte**Débit**Caudal de Flujo**Vazão***6 bar****Δ 1**

1350

**6 bar****Δ 0.5**

1050

**6 bar****\***

2050

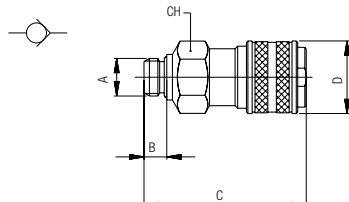
*\* Scarico libero - Exhaust Free - Kostenlose Auspuff - Échappement libre - Escape Libre - Descarga livre.***Filettatura****IT****Threads****GB****Gewindearten****DE***Gas cilindrica conforme ISO 228 Classe A.**Parallel gas in conformity with ISO 228 Class A.**Zylindrisches Gewinde nach Norm ISO 228 Classe A.***Filetages****FR****Roscas****ES****Roscas****PT***Filetage cylindrique conforme: ISO 228 Class A.**Gas cilíndrica conforme ISO 228 Clase A.**Gas paralela conforme ISO 228 Classe A.***401****PRESA MASCHIO***MALE SOCKET**VERSCHLUSS-KUPPLUNG MIT AUSSENGEWINDE**COUPLEUR MÂLE**ENCHUFE MACHO**SOQUETE COM ROSCA MACHO*

Code	A	B	C	D	CH	Pack.
00401 00 001	1/4	8	57	25.5	22	10
00401 00 002	3/8	9	58	25.5	22	10
00401 00 003	1/2	10	58	25.5	25	10

## 402

### PRESA FEMMINA

FEMALE SOCKET  
 VERSCHLUSS-KUPPLUNG MIT INNENGEWINDE  
 COUPLEUR FEMELLE  
 ENCHUFE HEMBRA  
 SOQUETE COM ROSCA FÊMEA

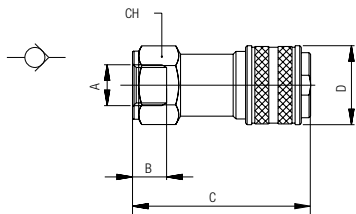

Code	A	B	C	D	CH	Pack.
00402 00 001	1/4	11	57.5	25.5	22	10
00402 00 002	3/8	12	58.5	25.5	22	10
00402 00 003	1/2	15	61.5	25.5	24	10

## 405

### PRESA CON PORTAGOMMA A RESCA

SOCKET WITH REST FOR RUBBER HOSE  
 VERSCHLUSS-KUPPLUNG MIT SCHLAUCHTÜLLE  
 COUPLEUR À DOUILLE ANNELÉE POUR TUBE  
 ENCHUFE ESPIGA  
 SOQUETE COM ESPIGÃO PARA TUBO DE BORRACHA

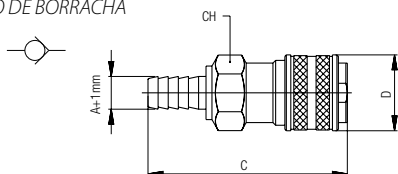

Code	A	C	D	CH	Pack.
00405 00 002	8	67	25.5	22	10
00405 00 003	10	67	25.5	22	10
00405 00 004	12	67	25.5	22	10

## 501AC

### INNESTO IN ACCIAIO MASCHIO

STEEL MALE PLUG  
 STECKER MIT AUSSENGEWINDE AUS STAHL  
 EMBOUT MÂLE EN ACIER  
 ADAPTADOR EN ACERO MACHO  
 PLUG EM AÇO COM ROSCA MACHO

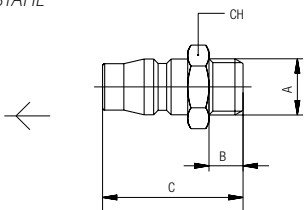

Code	A	C	D	CH	Pack.
501AC 00 51 03 ZI	1/4	8	33	17	10
501AC 00 51 04 ZI	3/8	9	34	19	10
501AC 00 51 05 ZI	1/2	10	35.5	24	10

Acciaio Indurito  
 Hardened Steel  
 Gehärtetem Stahl  
 Acier Trempé  
 Acero Curtido  
 Aço Endurecido

## 502AC

### INNESTO IN ACCIAIO FEMMINA

STEEL FEMALE PLUG  
 STECKER MIT INNENGEWINDE AUS STAHL  
 EMBOUT FEMELLE EN ACIER  
 ADAPTADOR EN ACERO HEMBRA  
 PLUG EM AÇO COM ROSCA FÊMEA

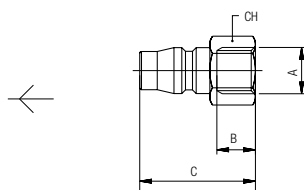

Code	A	C	D	CH	Pack.
502AC 00 51 03 ZI	1/4	11	33	17	10
502AC 00 51 04 ZI	3/8	12	33.5	19	10
502AC 00 51 05 ZI	1/2	15	37	24	10

Acciaio Indurito  
 Hardened Steel  
 Gehärtetem Stahl  
 Acier Trempé  
 Acero Curtido  
 Aço Endurecido

## 505AC

### INNESTO IN ACCIAIO CON PORTAGOMMA A RESCA

STEEL PLUG WITH REST FOR RUBBER HOSE  
 STECKER MIT SCHLAUCHTÜLLE AUS STAHL  
 EMBOUT À DOUILLE ANNELÉE POUR TUBE EN ACIER  
 ADAPTADOR EN ACERO ESPIGA  
 PLUG EM AÇO COM ESPIGÃO PARA TUBO DE BORRACHA

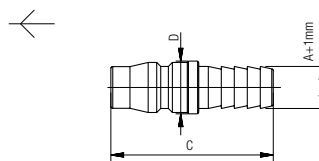

Code	A	C	D	Pack.
505AC 00 51 X7 ZI	8	39.5	13	10
505AC 00 51 X9 ZI	10	42.5	14	10
505AC 00 51 Y1 ZI	12	42.5	16	10

Acciaio Indurito  
 Hardened Steel  
 Gehärtetem Stahl  
 Acier Trempé  
 Acero Curtido  
 Aço Endurecido

Архангельск (8182)63-90-72  
 Астана (7172)727-132  
 Астрахань (8512)99-46-04  
 Барнаул (3852)73-04-60  
 Белгород (4722)40-23-64  
 Брянск (4832)59-03-52  
 Владивосток (423)249-28-31  
 Волгоград (844)278-03-48  
 Вологда (8172)26-41-59  
 Воронеж (473)204-51-73  
 Екатеринбург (343)384-55-89  
 Иваново (4932)77-34-06

Ижевск (3412)26-03-58  
 Иркутск (395)279-98-46  
 Казань (843)206-01-48  
 Калининград (4012)72-03-81  
 Калуга (4842)92-23-67  
 Кемерово (3842)65-04-62  
 Киров (8332)68-02-04  
 Краснодар (861)203-40-90  
 Красноярск (391)204-63-61  
 Курск (4712)77-13-04  
 Липецк (4742)52-20-81  
 Киргизия (996)312-96-26-47

Магнитогорск (3519)55-03-13  
 Москва (495)268-04-70  
 Мурманск (8152)59-64-93  
 Набережные Челны (8552)20-53-41  
 Нижний Новгород (831)429-08-12  
 Новокузнецк (3843)20-46-81  
 Новосибирск (383)227-86-73  
 Омск (3812)21-46-40  
 Орел (4862)44-53-42  
 Оренбург (3532)37-68-04  
 Пенза (8412)22-31-16  
 Казахстан (772)734-952-31

Пермь (342)205-81-47  
 Ростов-на-Дону (863)308-18-15  
 Рязань (4912)46-61-64  
 Самара (846)206-03-16  
 Санкт-Петербург (812)309-46-40  
 Саратов (845)249-38-78  
 Севастополь (8692)22-31-93  
 Симферополь (3652)67-13-56  
 Смоленск (4812)29-41-54  
 Сочи (862)225-72-31  
 Ставрополь (8652)20-65-13  
 Таджикистан (992)427-82-92-69

Сургут (3462)77-98-35  
 Тверь (4822)63-31-35  
 Томск (3822)98-41-53  
 Тула (4872)74-02-29  
 Тюмень (3452)66-21-18  
 Ульяновск (8422)24-23-59  
 Уфа (347)229-48-12  
 Хабаровск (4212)92-98-04  
 Челябинск (351)202-03-61  
 Череповец (8202)49-02-64  
 Ярославль (4852)69-52-93