

Serie 9000

RACCORDI A COMPRESSIONE

COMPRESSION FITTINGS

KLEMMRING VERSCHRAUBUNGEN

RACCORDS À BAGUES BICÔNE

RACORDAJE A COMPRESIÓN

CONEXÕES DE COMPRESSÃO



Архангельск (8182)63-90-72
Астана (7172)727-132
Астрахань (8512)99-46-04
Барнаул (3852)73-04-60
Белгород (4722)40-23-64
Брянск (4832)59-03-52
Владивосток (423)249-28-31
Волгоград (844)278-03-48
Вологда (8172)26-41-59
Воронеж (473)204-51-73
Екатеринбург (343)384-55-89
Иваново (4932)77-34-06

Ижевск (3412)26-03-58
Иркутск (395)279-98-46
Казань (843)206-01-48
Калининград (4012)72-03-81
Калуга (4842)92-23-67
Кемерово (3842)65-04-62
Киров (8332)68-02-04
Краснодар (861)203-40-90
Красноярск (391)204-63-61
Курск (4712)77-13-04
Липецк (4742)52-20-81
Киргизия (996)312-96-26-47

Магнитогорск (3519)55-03-13
Москва (495)268-04-70
Мурманск (8152)59-64-93
Набережные Челны (8552)20-53-41
Нижний Новгород (831)429-08-12
Новокузнецк (3843)20-46-81
Новосибирск (383)227-86-73
Омск (3812)21-46-40
Орел (4862)44-53-42
Оренбург (3532)37-68-04
Пенза (8412)22-31-16
Казахстан (772)734-952-31

Пермь (342)205-81-47
Ростов-на-Дону (863)308-18-15
Рязань (4912)46-61-64
Самара (846)206-03-16
Санкт-Петербург (812)309-46-40
Саратов (845)249-38-78
Севастополь (8692)22-31-93
Симферополь (3652)67-13-56
Смоленск (4812)29-41-54
Сочи (862)225-72-31
Ставрополь (8652)20-65-13
Таджикистан (992)427-82-92-69

Сургут (3462)77-98-35
Тверь (4822)63-31-35
Томск (3822)98-41-53
Тула (4872)74-02-29
Тюмень (3452)66-21-18
Ульяновск (8422)24-23-59
Уфа (347)229-48-12
Хабаровск (4212)92-98-04
Челябинск (351)202-03-61
Череповец (8202)49-02-64
Ярославль (4852)69-52-93

<https://aignep.nt-rt.ru/> || afp@nt-rt.ru



CARATTERISTICHE TECNICHE

TECHNICAL CHARACTERISTICS
TECHNISCHE ANGABEN
CARACTÉRISTIQUES TECHNIQUES
CARACTERÍSTICAS TÉCNICAS
CARACTERÍSTICAS TÉCNICAS



Norma di Riferimento

Reference standard

Entspricht der Norm

Norme de référence

Normativa de referencia

Norma de referência

1907/2006

REACH

2011/65/CE

RoHS

PED

2014/68/UE

SILICON

FREE

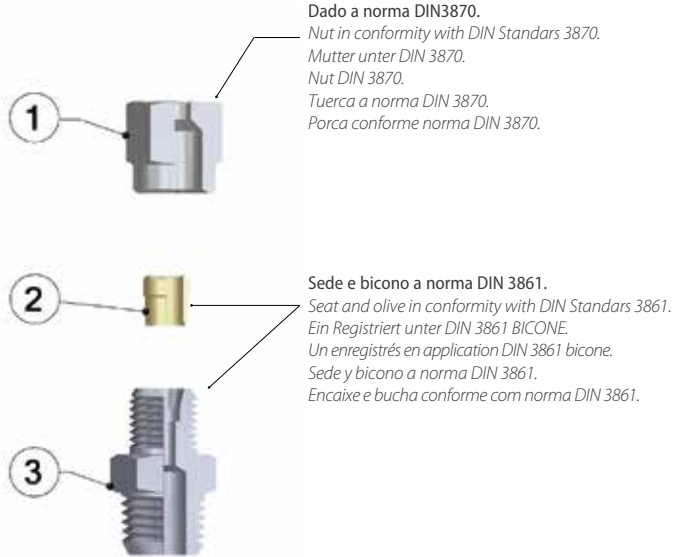

Dado a norma DIN3870.
Nut in conformity with DIN Standards 3870.
Mutter unter DIN 3870.
Nut DIN 3870.
Tuerca a norma DIN 3870.
Porca conforme norma DIN 3870.

Sede e bicono a norma DIN 3861.
Seat and olive in conformity with DIN Standards 3861.
Ein Registriert unter DIN 3861 BICONE.
Un enregistrés en application DIN 3861 bicone.
Sede y bicono a norma DIN 3861.
Encaixe e bucha conforme com norma DIN 3861.

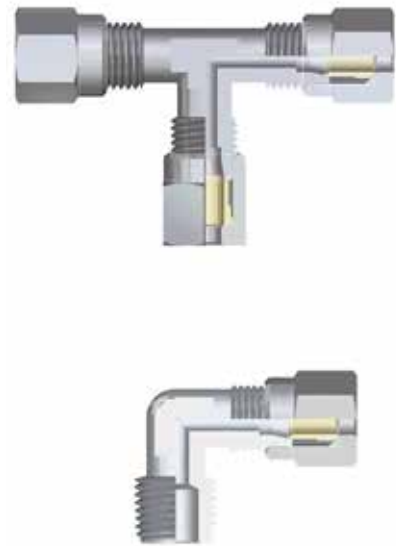

Materiali e Componenti

IT

- 1 Dado in Ottone nichelato
- 2 Ogiva in Ottone Ricotto
- 3 Corpo in Ottone nichelato

Component Parts and Materials

GB

- 1 Nickel-plated Brass Nut
- 2 Annealed Brass Olive
- 3 Nickel-plated Brass Body

Komponenten und Materialien

DE

- 1 Überwurfmutter Messing vernickelt
- 2 Klemmring Messing gegelüht
- 3 Körper Messing vernickelt

Matériaux et Composants

FR

- 1 Ecou: laiton nickelé
- 2 Bague bicono: laiton
- 3 Corps: laiton nickelé

Materiales y Componentes

ES

- 1 Tuerca en Latón niquelado
- 2 Bicono en Latón Recocido
- 3 Cuerpo en Latón niquelado

Materiais e Componentes

PT

- 1 Porca em Latão niquelado
- 2 Bucha em Latão Temperado
- 3 Corpo em Latão niquelado



Tubi di Collegamento

IT

Tubi in rame, ferro, acciaio, alluminio, ottone, PA.

Connection Tubes

GB

Tubes made in copper, steel, iron, aluminium, brass, PA.

Geeignete Rohre

DE

Rohre in Kupfer, Eisen, Stahl, Aluminium, Messing, PA.

Tubes Conseillés

FR

Tubes en cuivre, acier, aluminium, laiton, PA.

Tubos de Conexión

ES

Tubos en cobre, hierro, acero, aluminio, latón, PA.

Tubos de Conexão

PT

Tubos de cobre, ferro, aço, alumínio, latão, PA.



Filettatura

IT

Gas conica conforme ISO 7.1, BS 21, DIN 2999.
Gas cilindrica conforme ISO 228 Classe A.
Metrica conforme ISO R/262.

Threads

GB

Tapered gas in conformity with ISO 7.1, BS 21, DIN 2999.
Parallel gas in conformity with ISO 228 Class A.
Metric in conformity with ISO R/262.

Gewindearten

DE

Konisches Gewinde nach Norm ISO 7.1, BS 21, DIN 2999.
Zylindrisches Gewinde nach Norm ISO 228 Classe A.
Metrisches Gewinde nach Norm ISO R/262.

Filetages

FR

Filetage conique conforme: ISO 7.1, BS 21, DIN 2999.
Filetage cylindrique conforme: ISO 228 Classe A.
Filetage métrique conforme: ISO R/262.

Roscas

ES

Gas cónica conforme ISO 7.1, BS 21, DIN 2999.
Gas cilíndrica conforme ISO 228 Clase A.
Métrica conforme ISO R/262.

Roscas

PT

Gas cônica conforme ISO 7.1, BS 21, DIN 2999.
Gas paralela conforme ISO 228 Classe A.
Métrica conforme ISO R/262.



Temperature

Temperatures

Temperatur

Températures

Temperaturas

Temperaturas

- 60 °C

+ 300 °C



Fluidi compatibili

Acqua / Olio / Aria compressa

Fluidi in genere per l'impiantistica idraulica, oleodinamica, idropneumatica, ecc.

Fluids

Water / Oils / Compressed air

Fluids in general for the hydraulic, pneumatic and oildynamic plants etc.

Geeignete Medien

Wasser / Oel / Druckluft

Medien im Allgemeinen für hydraulische-, hydropneumatische- und pneumatische Anlagen, usw.

Fluides compatibles

Eau / Huile / Air comprimé

Fluides courants utilisés en hydraulique et pneumatique, etc.

Fluidos compatibles

Agua / Aceite / Aire comprimido

Fluidos en general para los campos hidráulicos, neumáticos y oleodinámicos, etc.

Fluidos compatíveis

Água / Óleo / Ar comprimido

Fluidos em geral para aplicações hidráulicas, oleodinâmicas, hidropneumáticas, etc.



Pressioni e Temperature

IT

Pressioni e temperature vengono determinate dal tipo di tubo impiegato, pertanto tali valori sono da definirsi in base alle caratteristiche del tubo stesso. Riportiamo di seguito i valori delle pressioni massime consigliate per l'utilizzo dei raccordi con tubi di rame dallo spessore di 1 mm a 20° C.

I valori delle pressioni consigliate, riportate in tabella, sono stati ottenuti dai valori di prova adottando un Coefficiente di Sicurezza 4.

Sono disponibili i certificati delle prove rilasciati dai vari laboratori che le hanno eseguite.

Pressures and Temperatures

GB

The working pressures and working temperatures depend on which type of tube is used, for this reason, the values must be determined in accordance with the tube's features.

Hereunder, we specify the values of the maximum pressure advised for the fittings at a temperature of 20° C connected with copper tube, which has a thickness of 1 mm.

The values of working pressures advised, specified in table have been obtained from the test values using a Safety Factor 4.

It is available the test report made by the external laboratory test.

Druckbereich und Temperatur

DE

Drücke und Temperaturen sind definiert durch die verwendete Ausführung der Leitung, d.h. die Werte der eingesetzten Rohre sind zu beachten.

Nachfolgend geben wir die Werte des maximalen Druckes für den Einsatz der Verschraubungen mit Kupferrohren an, deren Wandstärke min. 1mm beträgt und bei einer Temperatur von 20° C.

Es muss berücksichtigt werden, dass die angegebenen Druckwerte in der Tabelle mit einem Sicherheitsfaktors von 4 berechnet wurden.

Es stehen Prüfberichte zur Verfügung, die von verschiedenen, externen Labors gemacht wurden.

Pressions et Températures

FR

Les pressions et températures de service dépendent du type de tube utilisé. Pour cette raison, les valeurs doivent être déterminées en conformité avec les caractéristiques du tube. Ci-dessous, nous indiquons les valeurs de la pression maximale recommandée pour une connexion avec un tube en cuivre de 1 mm d'épaisseur à une température de 20° C.

Les pressions de service indiquées ont été calculées avec un coefficient de sécurité de 4.

Des rapports externes de tests sont disponibles sur demande pour attester ces valeurs.

Presiones y Temperaturas

ES

Presión y temperatura vienen determinadas según el tipo de tubo empleado, por lo tanto estos valores se definen en base a las características del mismo tubo. Representamos a continuación los valores de las presiones máximas aconsejadas para la utilización de los racores con tubo de cobre espesor 1 mm a 20° C.

Los valores de las presiones aconsejadas, representadas en la tabla, han sido obtenidas de valores de prueba adoptando un coeficiente de seguridad 4.

Están disponibles los certificados de las pruebas realizadas en distintos laboratorios especializados.

Pressões e Temperaturas

PT

Pressões e temperaturas dependem do tipo de tubo aplicado, portanto tais valores devem ser definidos com base nas características do tubo em questão.

A seguir apresentamos os valores das pressões máximas aconselhadas para a utilização das conexões com tubos de cobre de espessura de 1 mm a 20° C.

Os valores das pressões aconselhadas, reportados na tabela, foram obtidas dos valores de teste adotando-se um coeficiente de segurança 4.

Os certificados de teste executados por laboratórios externos estão disponíveis.

Misura Size Größe Dimensions Tamaño Tamanho	Pressione massima consigliata a 20 °C Maximum pressure advised at 20 °C Maximal Empfohlener Druck bei 20 °C Pression maximum conseillée à 20 °C Presión máxima aconsejada a 20 °C Pressão máxima aconselhada a 20 °C	
	kg/cm ²	bar
Ø		
4LL	130	128.6
6LL	180	178.1
8LL	150	148.4
10L	115	113.8
12L	75	72.4
14S	70	69.3
15S	70	69.3
16S	70	69.3
18L	65	64.3

9200

RACCORDO A T INTERMEDIO

TEE CONNECTOR

T-ANSCHLUSS

RACCORD TÉ

RACOR A T INTERMEDIO

CONEXÃO EM "T" TUBO-TUBO

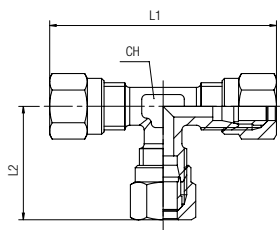

Code	Tube	L1	L2	CH	Pack.
09200 00 001	4	46	21	8	10
09200 00 002	6	48	22.5	9	10
09200 00 003	8	53	25	12	10
09200 00 004	10	65	31.5	13	10
09200 00 005	12	68	33	14	10
09200 00 006	14	76	42	17	10
09200 00 007	15	78	38	17	10
09200 00 008	16	86	42.5	19	10
09200 00 009	18	90	44	22	10

9220

RACCORDO A T MASCHIO CENTRALE

TEE MALE ADAPTOR - CENTRE LEG

T-EINSCHRAUBVERSCHRAUBUNG KONISCH

TÉ À PIQUAGE MÂLE CENTRAL, CONIQUE

RACOR A T MACHO CENTRAL

CONEXÃO EM "T" COM ROSCA MACHO CENTRAL

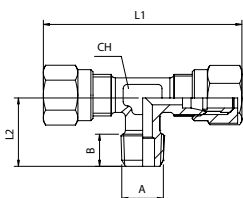

Code	Tube	A	B	L1	L2	CH	Pack.
09220 00 001	4	1/8	7.5	45	15	8	10
09220 00 002	6	1/8	7.5	45	16.5	9	10
09220 00 003	6	1/4	11	45	20.5	9	10
09220 00 004	8	1/8	7.5	52	17	12	10
09220 00 005	8	1/4	11	52	20.5	12	10
09220 00 006	8	3/8	11.5	50	24	13	10
09220 00 007	10	1/4	11	64	23.5	13	10
09220 00 008	10	3/8	11.5	64	24	13	10
09220 00 009	12	3/8	11.5	68	25	14	10
09220 00 010	12	1/2	14	68	26.5	14	10
09220 00 011	14	1/2	14	84	30	17	10
09220 00 012	15	1/2	14	76	28	17	10
09220 00 013	16	1/2	14	85	31.5	19	10
09220 00 014	18	1/2	14	88	34	22	10

9230

RACCORDO A T MASCHIO LATERALE

TEE MALE ADAPTOR OFF SET LEG

L-EINSCHRAUBVERSCHRAUBUNG KONISCH

TÉ À PIQUAGE LATÉRAL, CONIQUE

RACOR A T MACHO LATERAL

CONEXÃO EM "T" COM ROSCA MACHO LATERAL

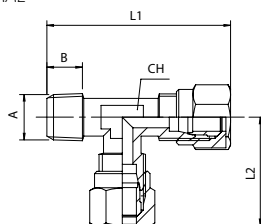

Code	Tube	A	B	L1	L2	CH	Pack.
09230 00 001	4	1/8	7.5	37.5	21	8	10
09230 00 002	6	1/8	7.5	39.5	22.5	9	10
09230 00 003	6	1/4	11	43	23	9	10
09230 00 004	8	1/8	7.5	43.5	25	12	10
09230 00 005	8	1/4	11	47	25	12	10
09230 00 006	8	3/8	11.5	50	25	13	10
09230 00 007	10	1/4	11	55.5	31	13	10
09230 00 008	10	3/8	11.5	56.5	31.5	13	10
09230 00 009	12	3/8	11.5	59	33	14	10
09230 00 010	12	1/2	11.5	59.5	25	15	10
09230 00 011	14	1/2	14	68	42	17	10
09230 00 012	15	1/2	14	68	38	17	10
09230 00 013	16	1/2	14	74.5	42.5	19	10
09230 00 014	18	1/2	14	79	44	22	10

9260

RACCORDO A L INTERMEDIO

ELBOW CONNECTOR

WINKELVERSCHRAUBUNG

RACCORD EQUERRE

RACOR A L INTERMEDIO

CONEXÃO EM "L" TUBO-TUBO

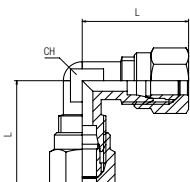

Code	Tube	L	CH	Pack.
09260 00 001	4	21	8	10
09260 00 002	6	22.5	9	10
09260 00 003	8	26.5	12	10
09260 00 004	10	31.5	13	10
09260 00 005	12	34.5	14	10
09260 00 006	14	38	17	10
09260 00 007	15	37.5	17	10
09260 00 008	16	44	19	10
09260 00 009	18	44	22	10

9280

RACCORDO A L MASCHIO
 ELBOW MALE ADAPTOR
 WINKELVERSCHRAUBUNG KONISCH
 EQUERRE MÂLE CONIQUE
 RACOR A L MACHO
 CONEXÃO EM "L" COM ROSCA MACHO

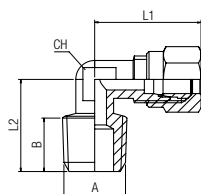

Code	Tube	A	B	L1	L2	CH	Pack.
09280 00 001	4	1/8	7.5	22	15	8	10
09280 00 002	6	1/8	7.5	23.5	17	9	10
09280 00 003	6	1/4	11	24	19.5	9	10
09280 00 004	8	1/8	7.5	26.5	18	12	10
09280 00 005	8	1/4	11	26.5	21.5	11	10
09280 00 006	8	3/8	11.5	29.5	24.5	13	10
09280 00 007	10	1/4	11	33	23.5	13	10
09280 00 008	10	3/8	11.5	33	24.5	13	10
09280 00 009	12	3/8	11.5	34.5	25	14	10
09280 00 010	12	1/2	14	34.5	28	15	10
09280 00 011	14	1/2	14	38.5	30	17	10
09280 00 012	15	1/2	14	37	29	17	10
09280 00 013	16	1/2	14	43	31.5	19	10
09280 00 014	18	1/2	14	44	33.5	22	10

9460

RACCORDO DIRITTO INTERMEDIO
 STRAIGHT CONNECTOR
 VERBINDUNGSVERSCHRAUBUNG
 RACCORD UNION DOUBLE
 RACOR RECTO INTERMEDIO
 CONEXÃO RETA TUBO-TUBO

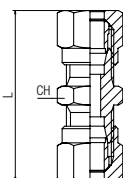

Code	Tube	L	CH	Pack.
09460 00 001	4	36	9	10
09460 00 002	6	39	12	10
09460 00 003	8	39	12	10
09460 00 004	10	48	17	10
09460 00 005	12	49	19	10
09460 00 006	14	53	24	10
09460 00 007	15	50	24	10
09460 00 008	16	53.5	27	10
09460 00 009	18	53	27	10

9480

RACCORDO DIRITTO MASCHIO
 STRAIGHT MALE ADAPTOR
 GERADE EINSCHRAUBVERSCHRAUBUNG KONISCH
 RACCORD DROIT MÂLE CONIQUE
 RACOR RECTO MACHO
 CONEXÃO RETA COM ROSCA MACHO

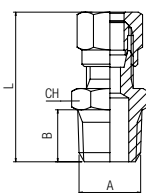

Code	Tube	A	B	L	CH	Pack.
09480 00 001	4	1/8	7.5	27.5	11	10
09480 00 002	6	1/8	7.5	28	11	10
09480 00 003	6	1/4	11	31.5	14	10
09480 00 004	8	1/8	7.5	30	12	10
09480 00 005	8	1/4	11	33.5	14	10
09480 00 006	8	3/8	11.5	35	17	10
09480 00 007	10	1/4	11	38	16	10
09480 00 008	10	3/8	11.5	38.5	17	10
09480 00 009	12	3/8	11.5	38.5	18	10
09480 00 010	12	1/2	14	41.5	21	10
09480 00 011	14	1/2	14	44	22	10
09480 00 012	15	1/2	14	43.5	22	10
09480 00 013	16	1/2	14	45	24	10
09480 00 014	18	1/2	14	45	26	10

9500

RACCORDO DIRITTO FEMMINA
 STRAIGHT FEMALE ADAPTOR
 AUFSCHRAUBVERSCHRAUBUNG
 RACCORD DROIT TARAUDEE
 RACOR RECTO HEMBRA
 CONEXÃO RETA COM ROSCA FÊMEA

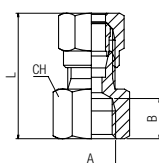

Code	Tube	A	B	L	CH	Pack.
09500 00 001	4	1/8	8.5	26.5	14	10
09500 00 002	6	1/8	8.5	26.5	14	10
09500 00 003	6	1/4	11	30	17	10
09500 00 004	8	1/8	8.5	27.5	14	10
09500 00 005	8	1/4	11	31	17	10
09500 00 006	8	3/8	11.5	32.5	20	10
09500 00 007	10	1/4	11	32.5	17	10
09500 00 008	10	3/8	11.5	34.5	20	10
09500 00 009	12	3/8	11.5	34.5	20	10
09500 00 010	12	1/2	15	39	24	10
09500 00 011	14	1/2	15	40	24	10
09500 00 012	15	1/2	15	39.5	24	10
09500 00 013	16	1/2	15	41	24	10
09500 00 014	18	1/2	15	41	26	10

9550

RACCORDO ORIENTABILE A L CON VITE

SINGLE BANJO BODY WITH STEM
WINKELSCHWENKVERSCHRAUBUNG (DREHBAR)
EQUERRE MÂLE BANJO, ORIENTABLE
RACOR ORIENTABLE A L CON TORNILLO
CONEXÃO EM "L" ORIENTÁVEL TIPO BANJO

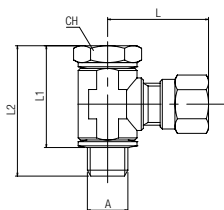

Code	Tube	A	L	L2	L1	CH	Pack.
09550 00 001	4	1/8	23	31	24	14	10
09550 00 002	6	1/8	24	31	24	14	10
09550 00 003	6	1/4	27.5	32	24.5	17	10
09550 00 004	8	1/8	27.5	31	24	14	10
09550 00 005	8	1/4	27.5	32	24.5	17	10
09550 00 006	8	3/8	30	37.5	24.5	19	10
09550 00 007	10	1/4	33	32	24.5	17	10
09550 00 008	10	3/8	33.5	36	27.5	19	10
09550 00 009	12	3/8	36	46	38	22	10

Temperature	min	max
	- 20 °C	+ 80 °C

9680

DADO

NUT
ÜBERWURFMUTTER
ECROU
TUERCA
PORCA

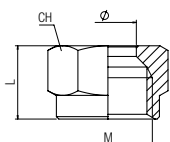

Code	Tube	L	CH	M	Pack.
09680 00 01 X1 NB	4 LL	11	10	M8x1	50
09680 00 01 X4 NB	6 LL	11.5	12	M10x1	50
09680 00 01 X7 NB	8 LL	12	14	M12x1	50
09680 00 01 X9 NB	10 L	15.5	19	M16x1.5	50
09680 00 01 Y1 NB	12 L	15.5	22	M18x1.5	50
09680 00 01 Y3 NB	14 S	18.5	27	M22x1.5	20
09680 00 01 Y4 NB	15 L	17	27	M22x1.5	20
09680 00 01 Y5 NB	16 S	18.5	30	M24x1.5	20
09680 00 01 Y7 NB	18 L	18	32	M26x1.5	20

9740

OGIVA

OLIVE
KLEMMRING
BAGUE BICÔNE
BICONO
BUCHA

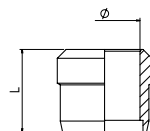

Code	Tube	L	Pack.
09740 00 02 X1 00	4 LL	6	50
09740 00 02 X4 00	6 LL	7	50
09740 00 02 X7 00	8 LL	7.5	50
09740 00 02 X9 00	10 L	9.5	50
09740 00 02 Y1 00	12 L	9.5	50
09740 00 02 Y3 00	14 S	9.5	20
09740 00 02 Y4 00	15 L	9.5	20
09740 00 02 Y5 00	16 S	9.5	20
09740 00 02 Y7 00	18 L	10	20

10770

BUSSOLA DI RINFORZO

INTERNAL SUPPORT BUSH
STÜTZHÜLSE MESSING
FOURRURE INTÉRIEURE
REFUERZO
BUCHA DE REFORÇO INTERNA

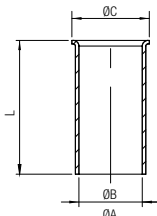

Code	Tube	A	B	C	L	Pack.
10770 00 01 1D 00	4/2.7	2.7	2.1	3.7	13	10
10770 00 01 3D 00	6/4	4	3.2	5	13	10
10770 00 01 4D 00	8/6	6	5	7	16.5	10
10770 00 01 5D 00	10/8	8	7	9	17	10
10770 00 01 7D 00	12/9	9	8	11	19	10
10770 00 01 8D 00	12/10	10	9	11	19	10
10770 00 01 0E 00	14/12	12	11	13.5	21	10
10770 00 01 1E 00	15/12.5	12.5	11.6	14	21	10
10770 00 01 3E 00	16/13	13	12	15.5	22	10
10770 00 01 7E 00	18/15	15	14	17.5	23	10
10770 00 01 8E 00	18/16	16	15	17.5	23	10
10770 00 01 0F 00	22/18	18	17	21	25	10

Архангельск (8182)63-90-72
Астана (7172)727-132
Астрахань (8512)99-46-04
Барнаул (3852)73-04-60
Белгород (4722)40-23-64
Брянск (4832)59-03-52
Владивосток (423)249-28-31
Волгоград (844)278-03-48
Вологда (8172)26-41-59
Воронеж (473)204-51-73
Екатеринбург (343)384-55-89
Иваново (4932)77-34-06

Ижевск (3412)26-03-58
Иркутск (395)279-98-46
Казань (843)206-01-48
Калининград (4012)72-03-81
Калуга (4842)92-23-67
Кемерово (3842)65-04-62
Киров (8332)68-02-04
Краснодар (861)203-40-90
Красноярск (391)204-63-61
Курск (4712)77-13-04
Липецк (4742)52-20-81
Киргизия (996)312-96-26-47

Магнитогорск (3519)55-03-13
Москва (495)268-04-70
Мурманск (8152)59-64-93
Набережные Челны (8552)20-53-41
Нижний Новгород (831)429-08-12
Новокузнецк (3843)20-46-81
Новосибирск (383)227-86-73
Омск (3812)21-46-40
Орел (4862)44-53-42
Оренбург (3532)37-68-04
Пенза (8412)22-31-16
Казахстан (772)734-952-31

Пермь (342)205-81-47
Ростов-на-Дону (863)308-18-15
Рязань (4912)46-61-64
Самара (846)206-03-16
Санкт-Петербург (812)309-46-40
Саратов (845)249-38-78
Севастополь (8692)22-31-93
Симферополь (3652)67-13-56
Смоленск (4812)29-41-54
Сочи (862)225-72-31
Ставрополь (8652)20-65-13
Таджикистан (992)427-82-92-69

Сургут (3462)77-98-35
Тверь (4822)63-31-35
Томск (3822)98-41-53
Тула (4872)74-02-29
Тюмень (3452)66-21-18
Ульяновск (8422)24-23-59
Уфа (347)229-48-12
Хабаровск (4212)92-98-04
Челябинск (351)202-03-61
Череповец (8202)49-02-64
Ярославль (4852)69-52-93